

INSTALLATION INSTRUCTIONS

JOHN DEERE CONSERVAPAK



2110 Park Avenue Brandon, Manitoba, Canada R7B 0R9

Website: www.atomjet.com

Email: agriculture@atomjet.com

Phone: 1.204.728.8590

Fax: 1.204.726.5734

Toll Free: 1.800.573.5048

IMPORTANT WARRANTY/GUARANTEE INFORMATION

DO NOT DESTROY

Any claims under the guarantee must be COMPLETED BY OCTOBER 31 IN THE YEAR OF PURCHASE to qualify for a full refund. To satisfy a claim, Atom-Jet Industries must be given the opportunity during the seeding season to rectify the problem or issue, if NOT THE GUARANTEE IS NULL AND VOID. Wear under normal use is not covered by warranty/guarantee.

To activate your warranty registration, scan this QR code using the application on your mobile device and fill out the online form. Upon receipt of the completed form, we will send you a free pair of Atom-Jet work gloves.



WARRANTY IS TO BE COMPLETED BY OCTOBER 31 IN THE YEAR OF PURCHASE. The openers will either be Replaced or Repaired during this period. If you need to return an opener for warranty, please enclose your name, the farm name, address, phone number with area code, dealer purchased from, number of openers purchased, and the date of purchase. Please enclose copy of original invoice. Inclusion of the information will significantly speed up your warranty claim.

Get a
GOOD START
"IF SEEDING ISN'T DONE RIGHT, NOTHING ELSE MATTERS."

Before you start

Ensure shank cavity is free of dirt and debris before installing fertilizer knives. Dirt build-up will prohibit the fertilizer knives from sliding far enough into the shank and the bolt hole will not line up.

This instruction set is for all Atom-Jet fertilizer and seed knives for the John Deere Conservapak air drill. Find the section that matches your openers and follow those instructions.

Fertilizer Knife Installation

Granular Fertilizer

If you have a fertilizer knife with part number **ZT-CPAW00**, follow these steps:

1. Slide the fertilizer knife into the shank until the bolt hole lines up
2. Insert the hex head bolt as shown in Figure 1
3. Install the nut and tighten with 9/16 wrenches
4. Install the fertilizer hose in granular tube
5. Install the hose clamp as shown below, tighten using 5/16 nut driver

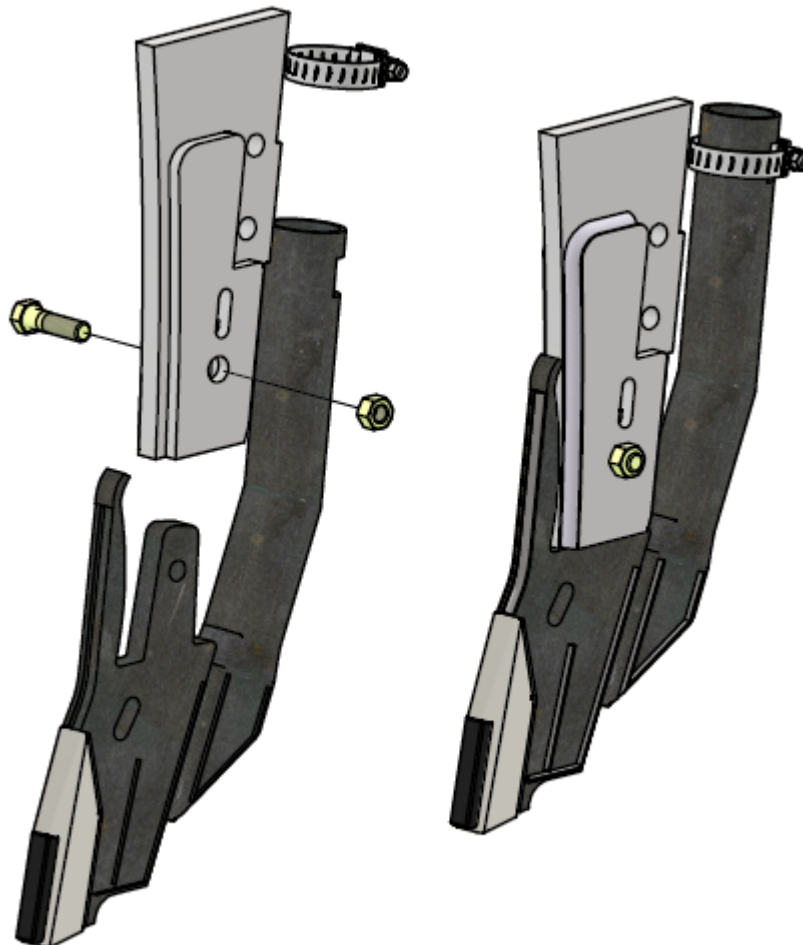

Figure 1: Granular fertilizer knife installation

Granular Fertilizer and NH3

If you have a fertilizer knife with one of the following part numbers, follow these steps:

- **ZT-CPAW12**
- **ZT-CPAW13**
- **ZT-CPAW14**

1. Slide the fertilizer knife into the shank until the bolt hole lines up
2. Insert the hex head bolt as shown in Figure 2
3. Install the nut and tighten with 9/16 wrenches
4. Install the fertilizer hose in granular tube
5. Install the NH3 hose on stainless tube
6. Install hose clamps as shown below. Tighten using 5/16 nut driver

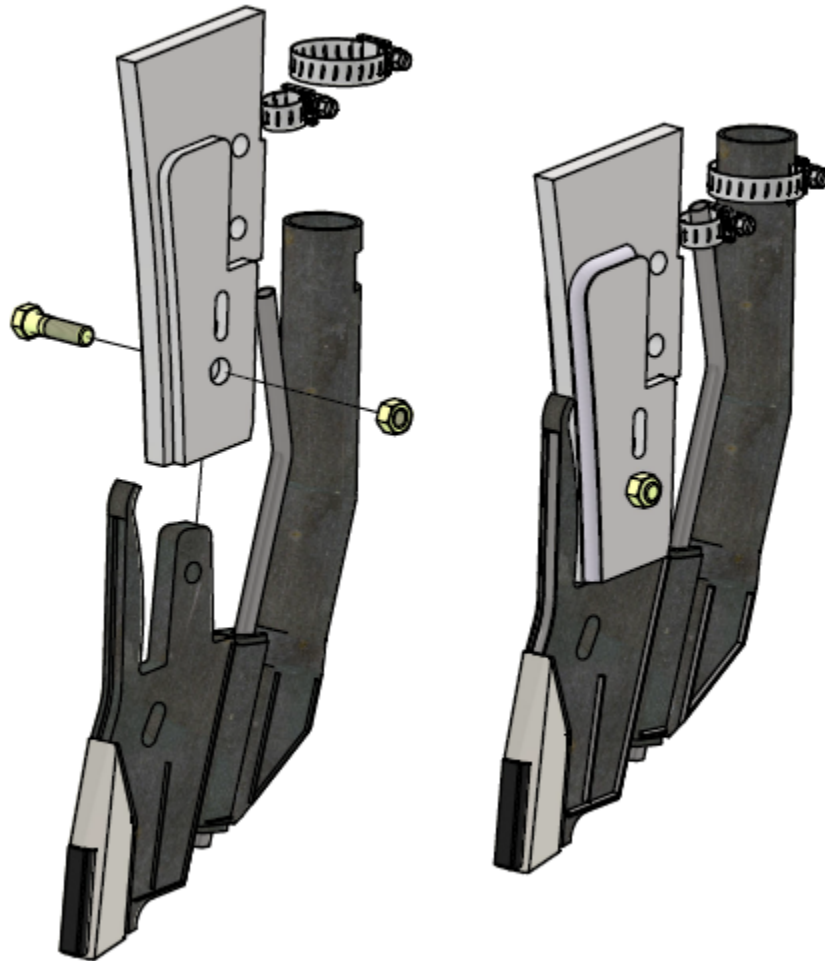

Figure 2: Granular and NH3 fertilizer installation

MaxQuip NH3 Connection and Granular Fertilizer

If you have a fertilizer knife with a MaxQuip connection, follow these steps:

- 1) Slide the fertilizer knife into the shank until the bolt hole lines up
- 2) Insert the hex head bolt as shown in Figure 3
- 3) Install the nut and tighten with 9/16 wrenches
- 4) Insert the MaxQuip line through the hose crimp and slide over the small MaxQuip tube as shown in Figure 4
- 5) Crimp line to the MaxQuip tube with crimping tool (Tool and crimps available through MaxQuip)
- 6) Slide the ½" protective NH3 tube (not supplied) over the MaxQuip connection as seen in Figure 5
- 7) Use the provided #6 hose clamp to secure the protective cover to the opener
- 8) Install the #20 hose clamp on the granular tube and tighten using a 5/16 nut driver

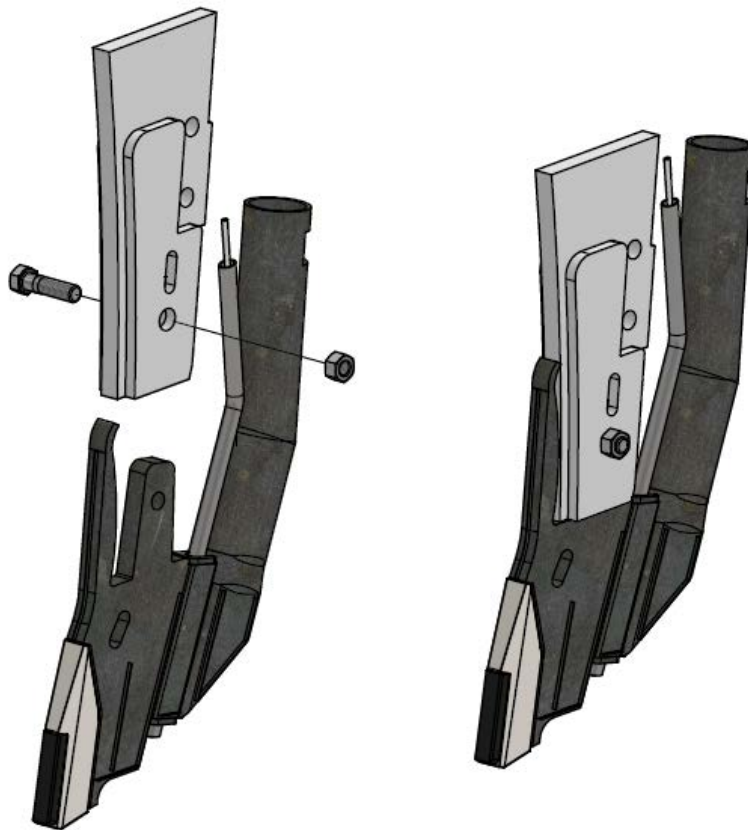

Figure 3: Mount MaxQuip fertilizer knife

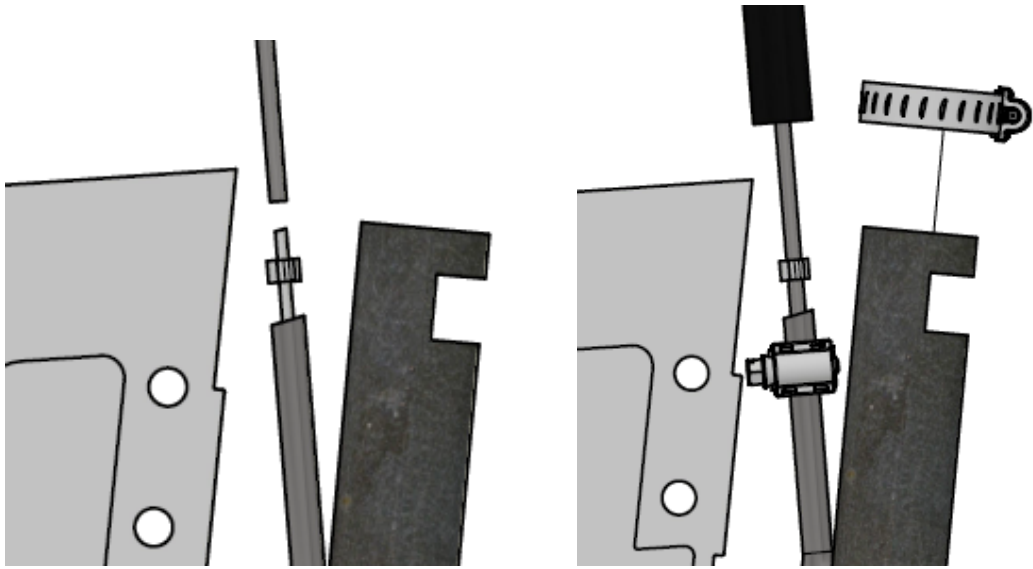

Figure 4: Install MaxQuip connection

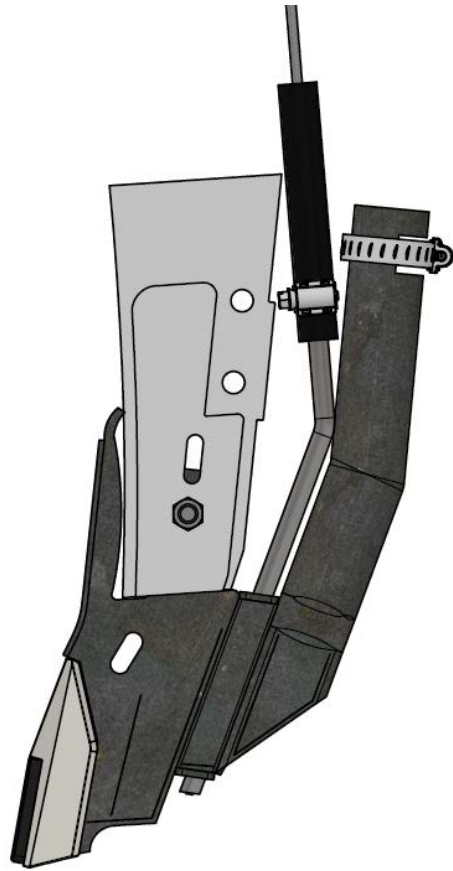

Figure 5: Install protective cover and granular tube

Liquid Fertilizer Installation

If you have a fertilizer knife with one of the following part numbers, follow these steps:

- **ZT-CPAW32**
- **ZT-CPAW33**
- **ZT-CPAW34**

1. Slide the fertilizer knife into the shank until the bolt hole lines up
2. Insert the hex head bolt as shown in Figure 6
3. Install the nut and tighten with 9/16 wrenches
4. Install the fertilizer hose on the stainless tube
5. Install the hose clamp as shown below. Tighten using a ¼ nut driver

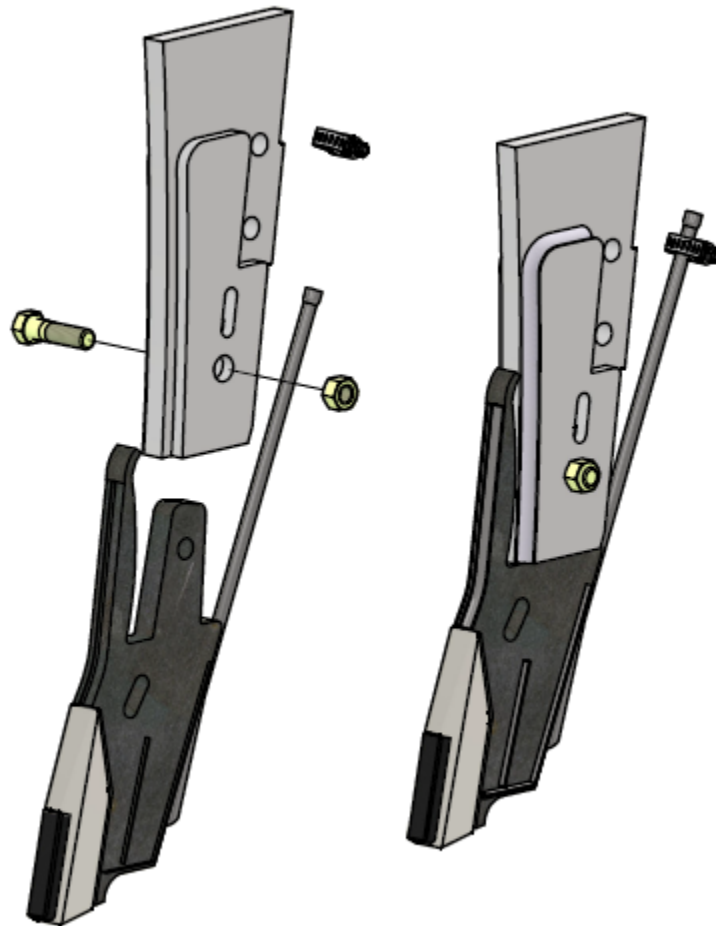

Figure 6: Liquid fertilizer knife installation

Seed Knife Installation

Paired Row Installation

Follow these steps for installing paired row openers:

1. Slide the opener over the seed tube on the shank until the bolt holes line up
2. Insert the bolts as shown in Figure 7 (Note: they go opposite direction than OEM bolts)
3. Install the nuts and tighten with 13mm wrenches

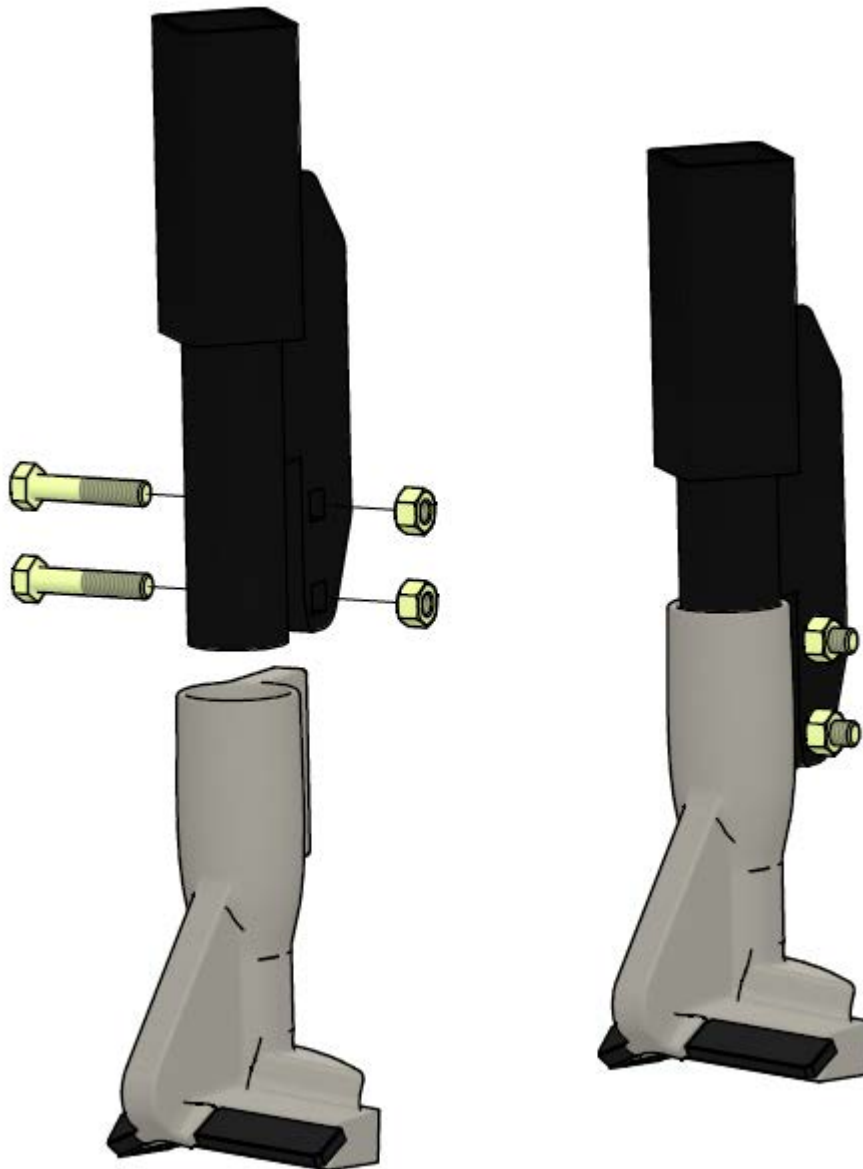

Figure 7: Paired row seed knife installation

Single Shoot Installation

Follow these steps for installing single shoot openers:

1. Slide the opener over the seed tube on the shank until the bolt holes line up
2. Insert the carriage bolts as shown in Figure 8
3. Install the nuts and tighten with 13mm wrench

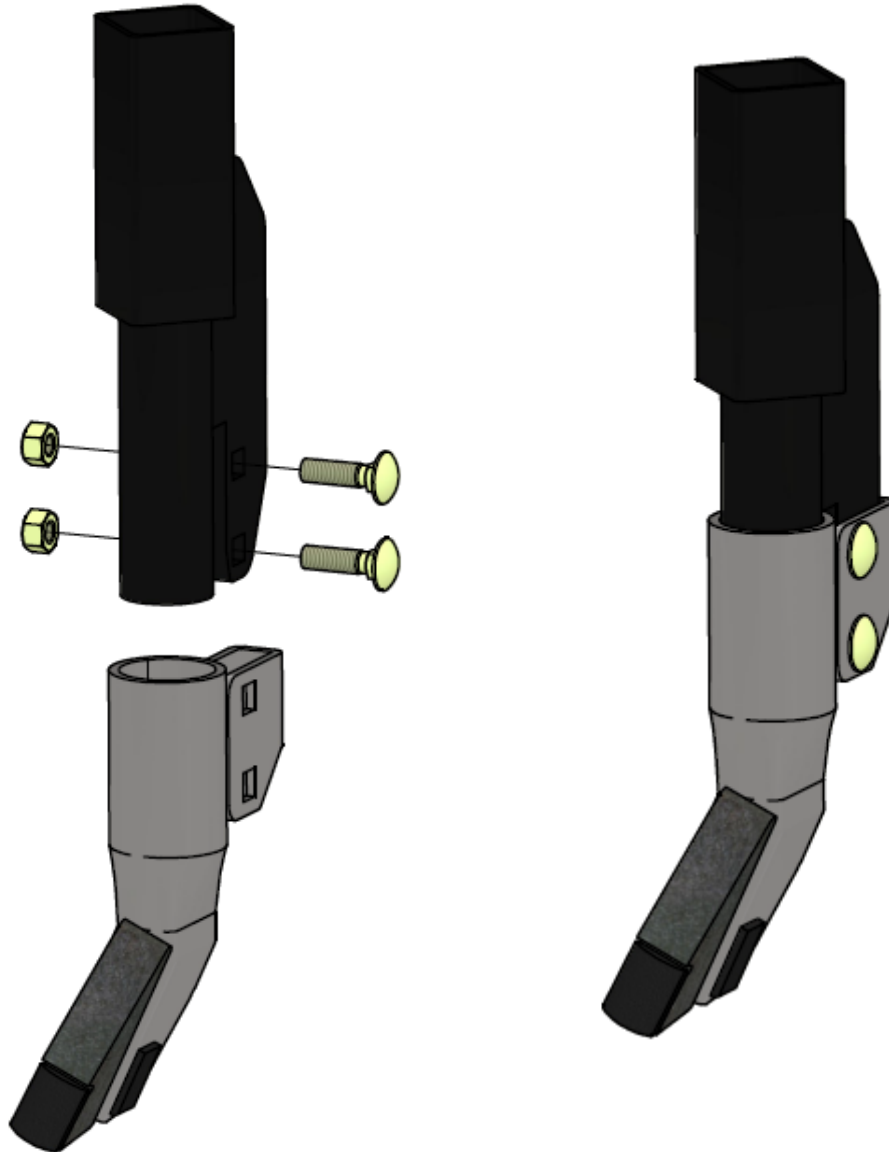

Figure 8: Single shoot seed knife installation